

DRAWING REV	DESCRIPTION OF CHANGES	DRAWER	DATE
01	Initial Release	N/A	2020-11-05

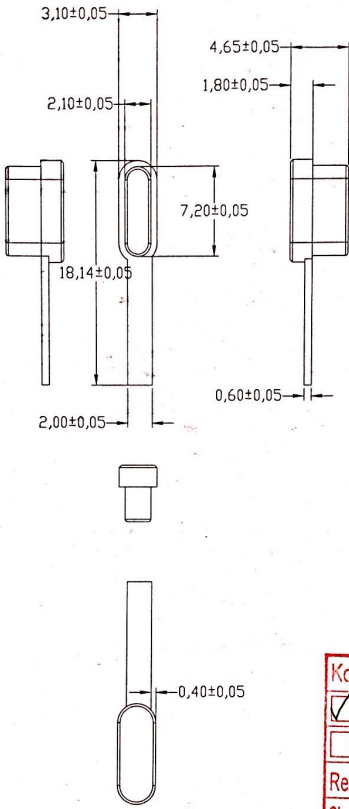

科锐塑胶工业(中山)有限公司  
 生效日期: 2020-11-26  
 受控文件

Kore Industries Zhongshan Co., Ltd.  
 New Tooling 新模     Transfer Tooling 转模  
 Modification 改模     Reference 参考  
 Remarks 备注:  
 Sign & Date 签名 & 日期: [Signature] 26 Nov 2020  
 Resp. Dept. 发放部门: DC, PE, Design.

未标注尺寸公差 (mm)	
X.	±0.10
X.X	±0.05
X.XX	±0.01

KORE INDUSTRIES			PROJECTION
DRAWER	MOULD NO	K2009003	HARDENING -
CUSTOMER	CUSTOMER	珠海赤子芯	MOULD SIZE -
CHECKED	PART NAME	按键	SIZE -
APPROVED	DRAW NO	-	SCALE 1:1
	QTY	1	SHEET NO 1 of 1
	MATERIAL	-	UNIT: REV:01



ISSUING REV.	DESCRIPTION OF CHANGES	ISSUER	DATE
01	Initial Release	N/A	2020-11-05

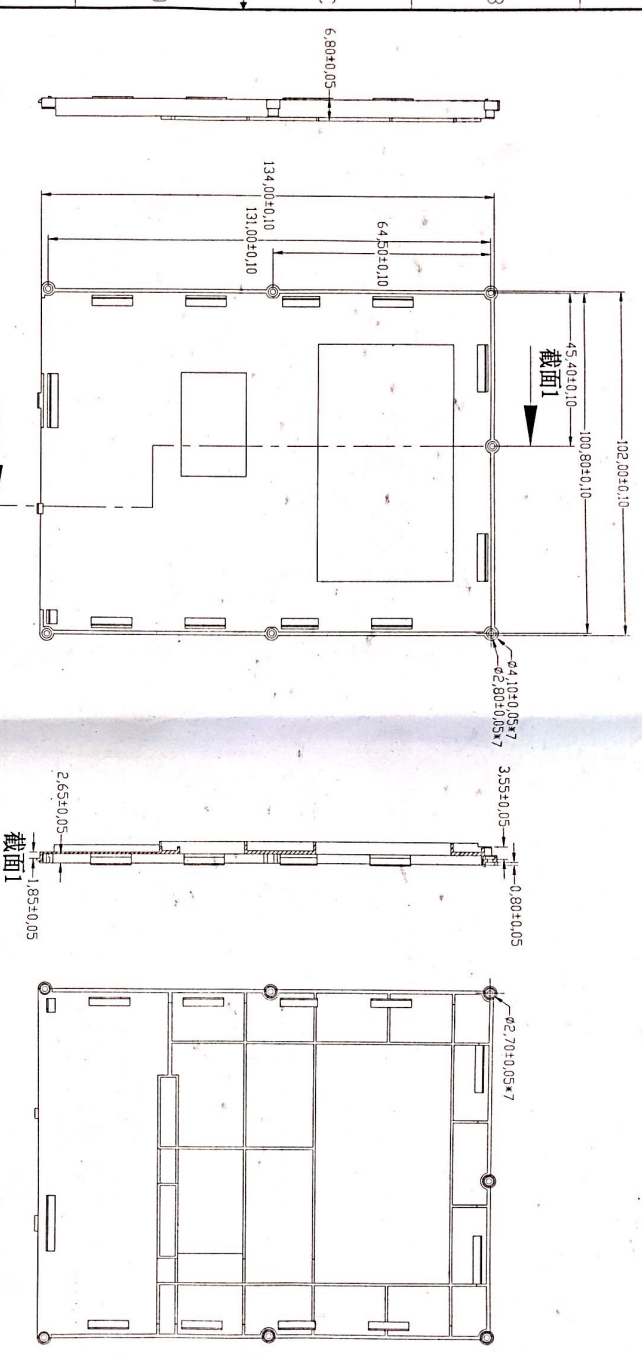

科德数控工业(中山)有限公司  
 生效日期 2020/11/28  
 受控文件

科德数控工业(中山)有限公司  
 生效日期 2020-11-26  
 受控文件

Kode Industries Zhongshan Co., Ltd.

New Tooling/模  Transfer Tooling/转模

Modification/模  Reference/参考

Remarks/备注: *Sign & Date/签字日期* *Responsible/负责人*

Resp. Dept./负责部门: *QC, PE, Design*

未标注尺寸公差 (mm)	
X	±0.10
XX	±0.05
XXX	+0.01

DRAWER	MOULD NO.	K2009003	HASBEARING	-
CHECKED	CUSTOMER	珠海乔丹	MOULD SIZE	-
APPROVED	PART NAME	中盘	SCALE	1:1.5
	DRAW. NO.	1	SHEET NO.	1 of 1
	MATERIAL	-	UNIT	REV.01



扫描全能王 创建

DRAWING REV	DESCRIPTION OF CHANGES	DRAWN/K	DATE
01	Initial Release	N/A	2020-11-05

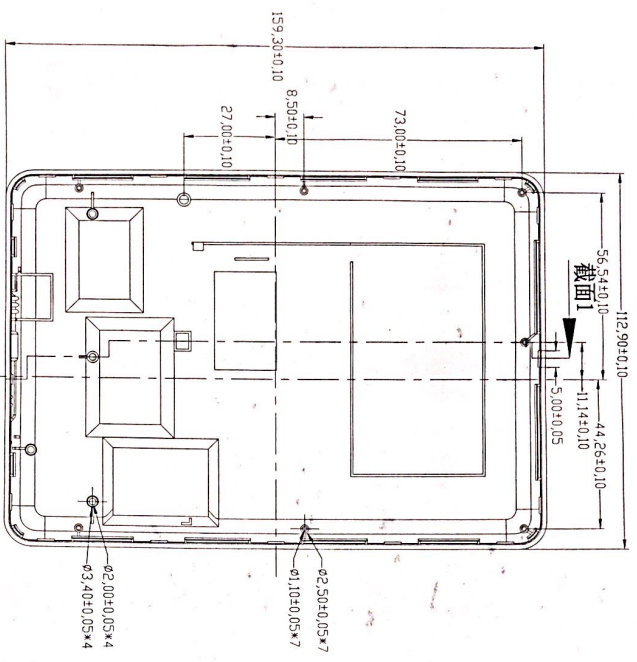
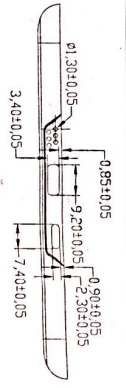

截面1

截面1

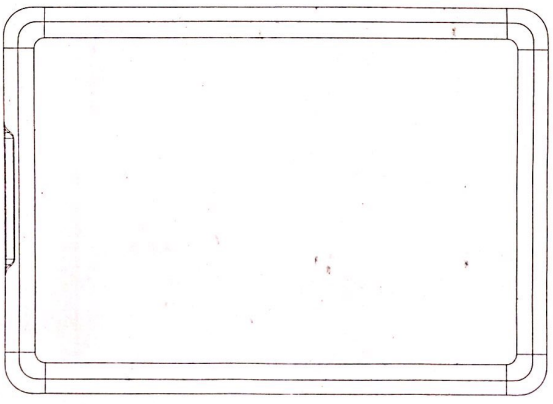
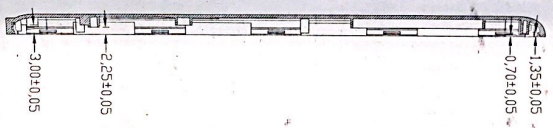

科德隆工业(中山)有限公司  
日期: 2020-11-26  
生效: 受控文件

Kode Industries Zhongshan Co., Ltd.  
 New Tooling模  
 Medication模  
 Transfer Tooling模  
 Reference参考  
 Remarks备注: 火爐  
 Sign & Date 簽名日期: 盧亞華  
 Prep Dept 準備部門: 盧亞華

未标注尺寸公差 (mm)		PRODUCTION	
X	±0.10		1 of 1
X.X	±0.05		
X.XX	±0.01		
DRAWER	[REDACTED]	SCALE	1 of 1
CHECKED	[REDACTED]	SHEET NO	REV:01
CUSTOMER	珠海科德隆	SCALE	
PART NAME	上蓋	SHEET NO	
DRAW NO		UNIT	
QTY	1		
MATERIAL			

DRAWING REV	DESCRIPTION OF CHANGES	DRAWER	DATE
01	Initial Release	N/A	2020-11-05

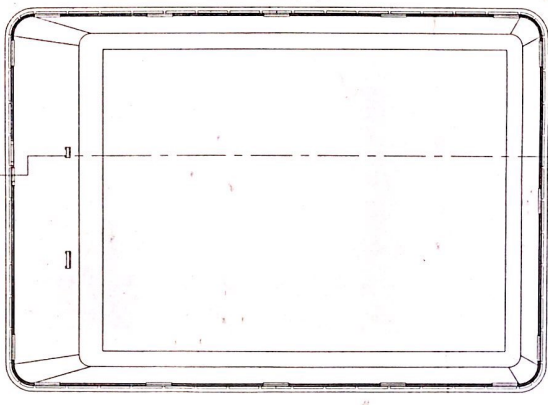
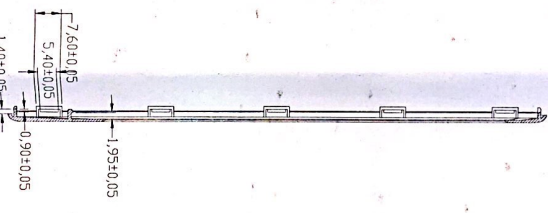
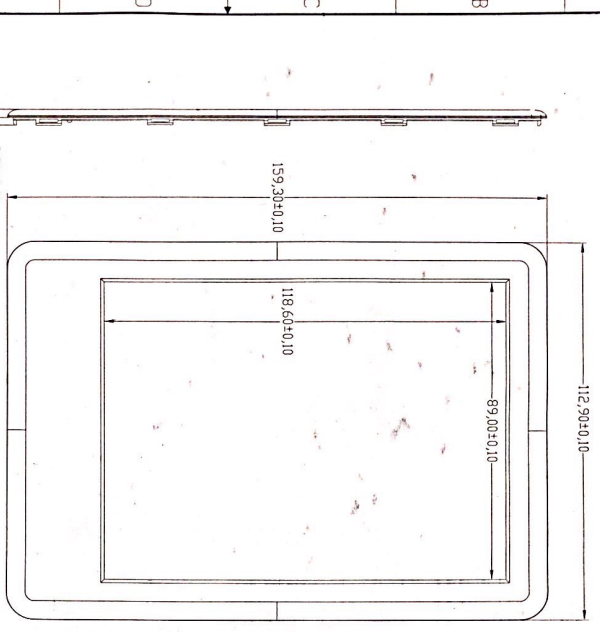

特德数控工业(中山)有限公司  
 生效日期: 2020-11-20  
 受控文件

Kore Industries Zhongshan Co., Ltd.  
 New Tooling 新模  
 Modification 改模  
 Transfer Tooling 转模  
 Reference 参考  
 Remarks 备注: \_\_\_\_\_  
 Sign & Date 签名日期: *Handwritten Signature*  
 Resp. Dept. 负责部门: *QC Dept.*

DRAWER	K0209003	HAS/DENING	1111
CUSTOMER	珠海芬智	SCALE	1:1
PART NAME	上盖	SHEET NO.	1 of 1
DRAW NO.	-	REV.01	-
DIV	1		
MATERIAL	-		

1 2 3 4 5 6 7 8 A3