

科锐塑胶工业(中山)有限公司
 生效 2021-02-25 日期
 受控文件

Kore Industries Zhongshan Co., Ltd.
 New Tooling 新模 Transfer Tooling 转模
 Modification 改模 Reference 参考
 Remarks 备注:
 Sign & Date 签名&日期: 游永发 21.2.25
 Resp. Dept. 发放部门: QC.PE. 模具设计

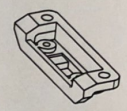

SCALE 1:1

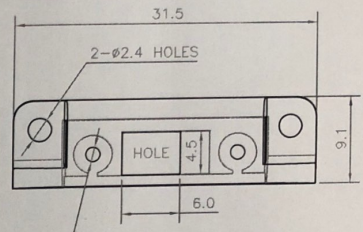
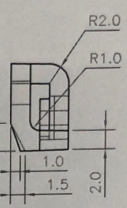
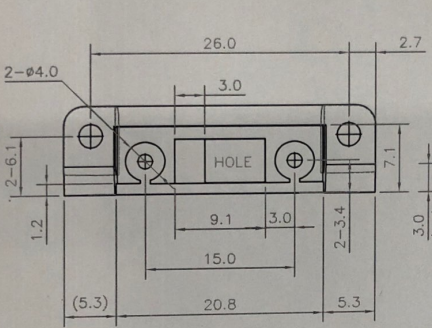
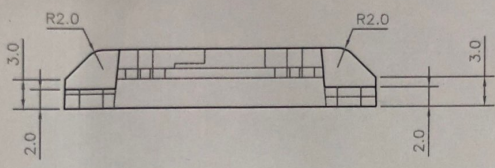
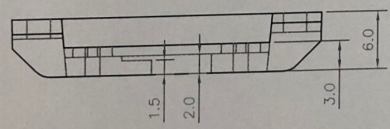

PERMISSIBLE DEVIATION IN DIMENSION WITHOUT TOLERANCE INDICATION FOR MOLDED PLASTIC (±mm)				
RANGE	CLASS A	CLASS B	CLASS C	CLASS G
L ≤ 6	0.08	0.16	0.3	
6 < L ≤ 30	0.1	0.2	0.4	
30 < L ≤ 120	0.2	0.4	0.8	
120 < L ≤ 300	0.4	0.8	2.0	
300 < L ≤ 600	0.8	2.0	4.0	
600 < L ≤ 1200	2.0	4.0	8.0	

NOTE:
 ROHS COMPLIANCE 2.0
 COLOR: Bk005 INDIGO BLACK
 DRAFT ANGLES REFER TO 3D

③		
②		
①		
DATE	ALTERATIONS	SIGN

G E N E R A L I N F O	SIZE	MATERIAL ABS(HB)	FINISHING ~ ()	DEPT R&D	DIGI SINGAPORE							
	HOLE POSITION	MATERIAL SIZE t = 2.0	HEAT TREATMENT	SCALE 2/1	UNIT mm	APPROVED	VERIFIED	CHECKED	DESIGNED	DRAWN		
	HOLE SIZE	SURFACE TREATMENT	HARDNESS	DATE 30.08.2017		HUI KOON	DERRICK		RW	RW		
PARTS NAME	COVER BV (PEEL SENSOR)			PART CODE	4 40174 028 048 00		MODEL	SM-6000	P.SIZE	A4	FILE TYPE	Master